

Mobiles for Data Entry

Prof. Timothy Gonsalves

Dept of Computer Science & Engg
TeNeT Group,
IIT-Madras

- 300m mobiles in India by 2008, 1m per month
- 70-80% population covered by GSM/CDMA
- Much lower PC/Internet Penetration
 - ⇒ Mobile as a ubiquitous portable data entry device even when coverage not there

- “Can Biosurveillance Algorithms coupled with Pervasive Mobile Applications potentially be effective in the early detection of disease outbreaks?”

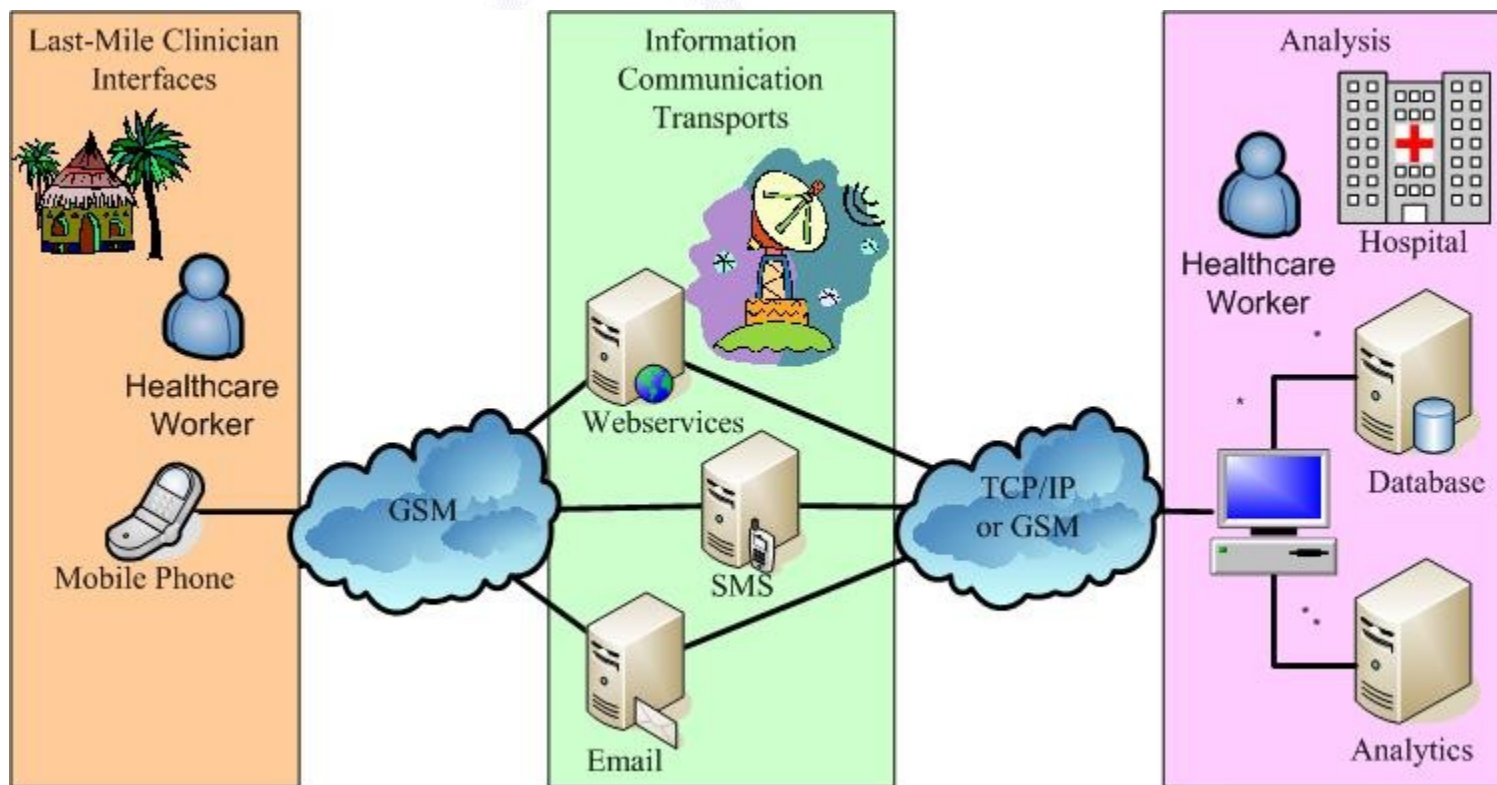

Mobile OS Market Share

• Symbian	-	72%
• Linux	-	13%
• Windows CE	-	6%
• Blackberry OS	-	5%
• Palm OS	-	1.6%
• Apple OS	-	1.3%

Typical Mobile Software Stack

Applications	Applications
	Java
Application Frameworks	
Multimedia	Communications
Core OS Services	

Android Software Stack

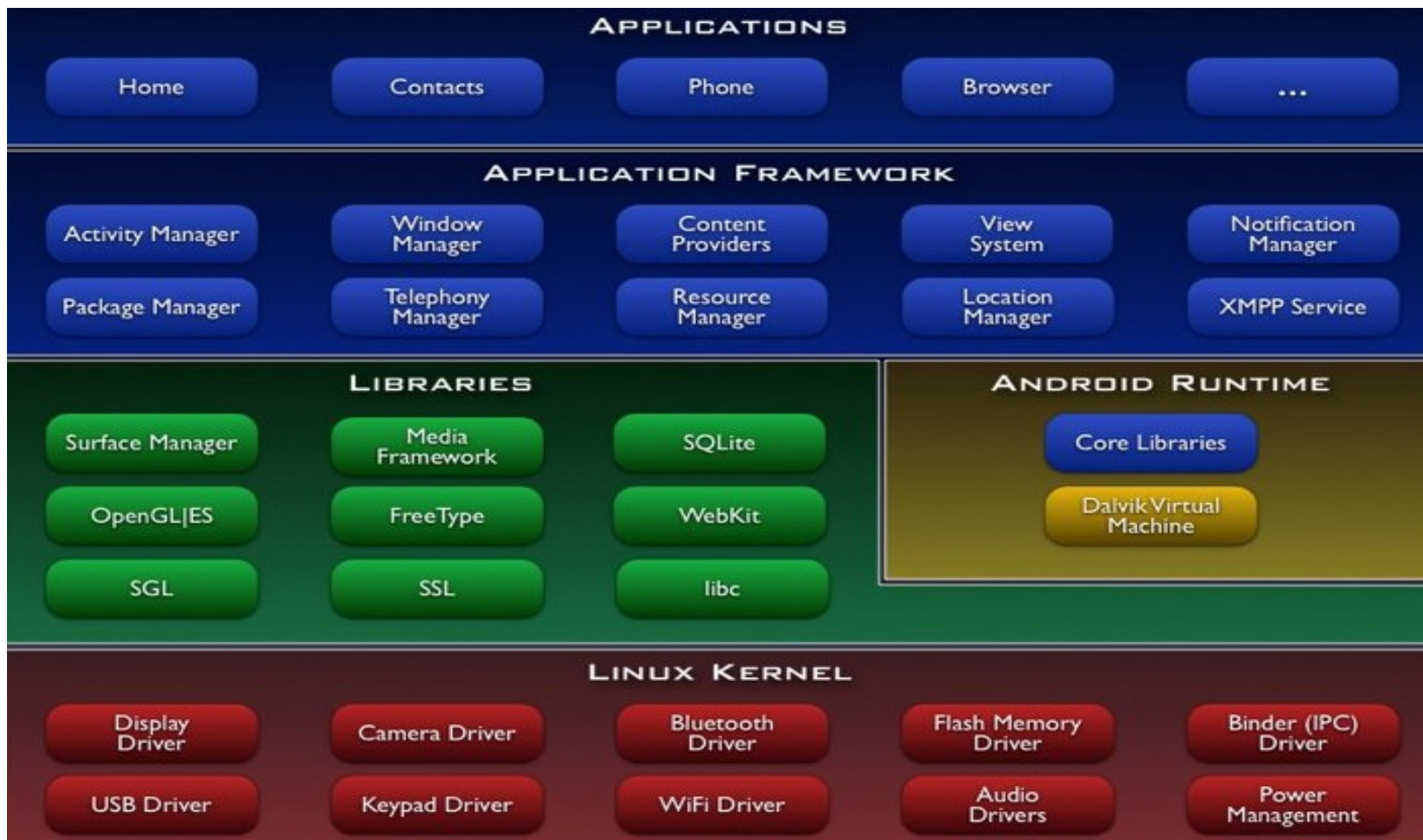

- iPDA like solution to be made available mobile phones with touch screen
- <http://www.d-tree.org/>

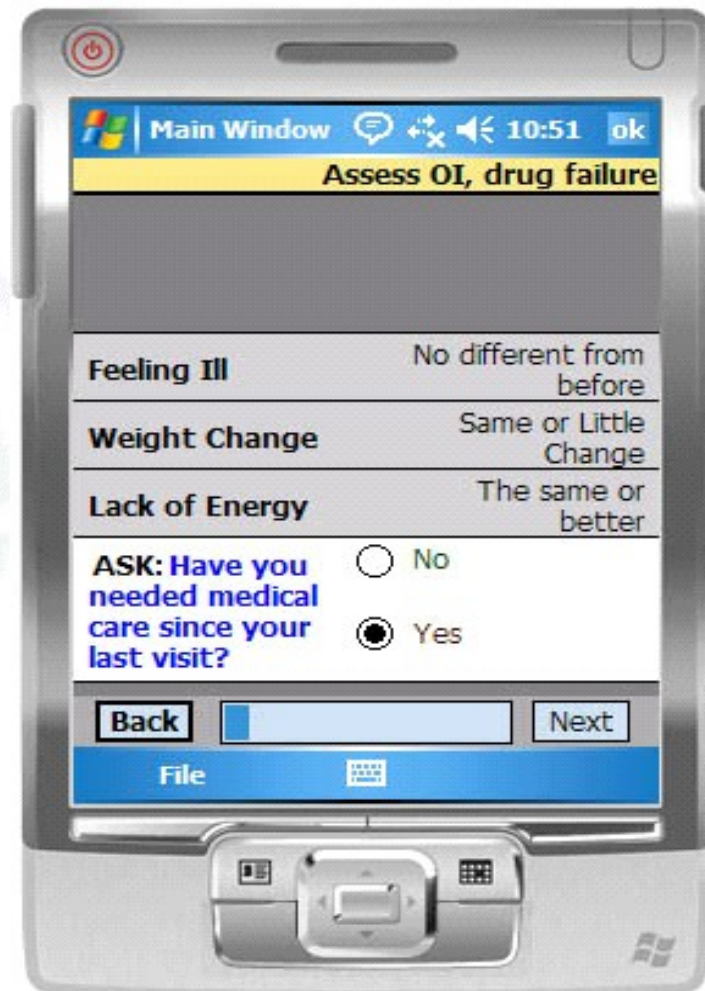

1. Write in C/C++ for specific OS
2. Write in Java, runs on most phones
3. Use a toolkit:

FRED (Acceltree, Pune, India)

– Ported to most phones

Android (Google)

– Linux phones

OpenRosa (Open source)

– a proposed standard

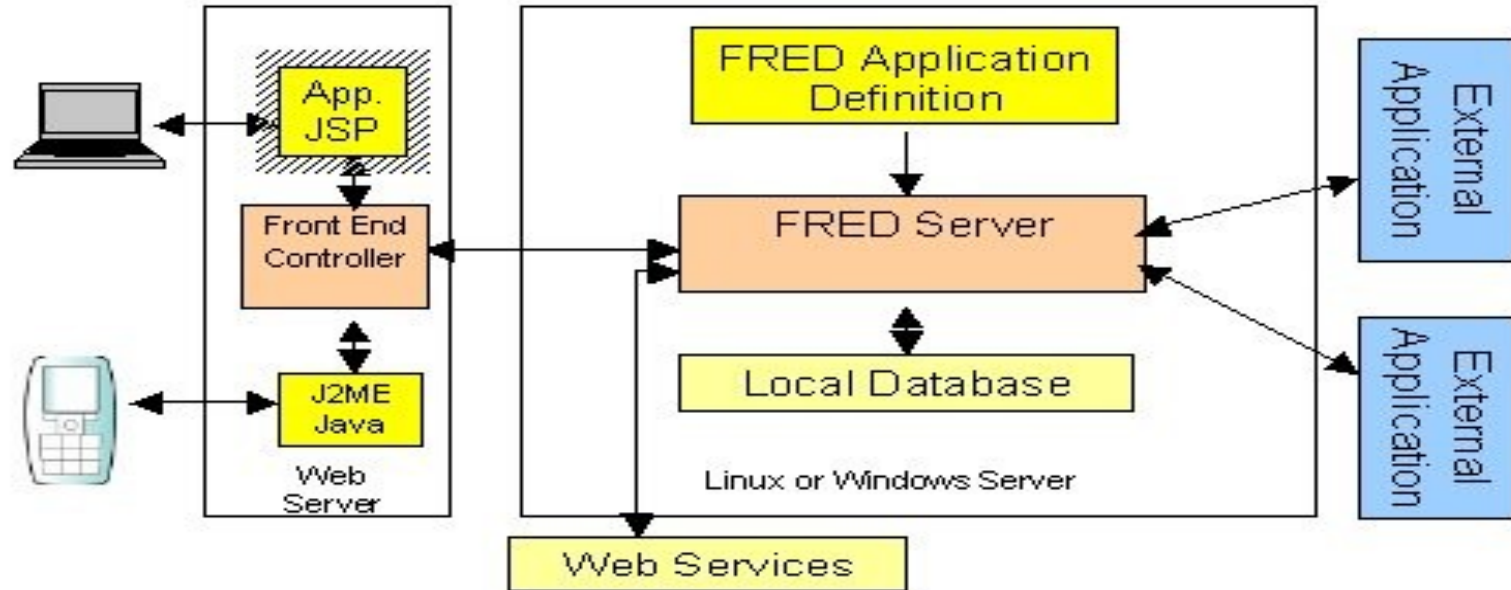

- Forms-based data entry from browsers and mobiles
- Server-side interface to popular DBMS
- Several clients including micro-finance